

INSTRUCTION MANUAL

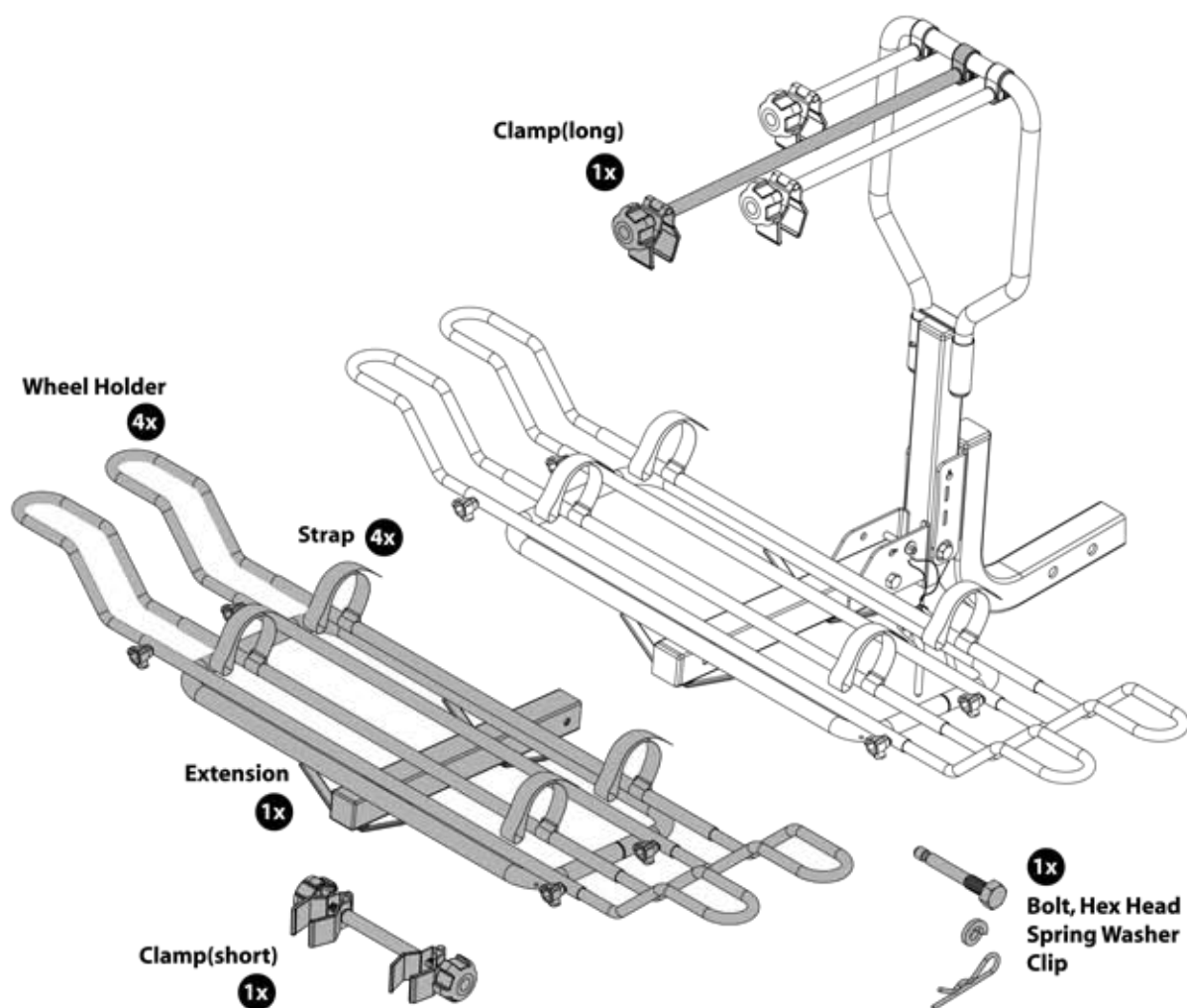

MADE IN TAIWAN

WARNING

1. Platform Extension for BC-08581-2A.
2. Check periodically to assure that the bikes have not moved and that even weight distribution is being maintained.
3. It is the owner's responsibility to periodically check to assure all hardware, straps, etc. are securely tightened for continued safety.
4. Do not create any downward vertical force on any part of the carrier when securing and tying the bike(s) to the carrier. Excessive downward vertical force beyond the carrier's load capacity may cause damage to the carrier, bikes and/or vehicle.
5. Keep the bike wheels away from the exhaust.
6. The original dimension of the vehicle will be much larger due to the extra carrier. Watch out!
7. Slow down when driving with bike carrier/bikes on the vehicle.
8. Designed to carry regular bikes; not available for tandem bikes.
9. Safety Pin must be secured in place at all times when the Carrier is in either folded or unfolded positions.

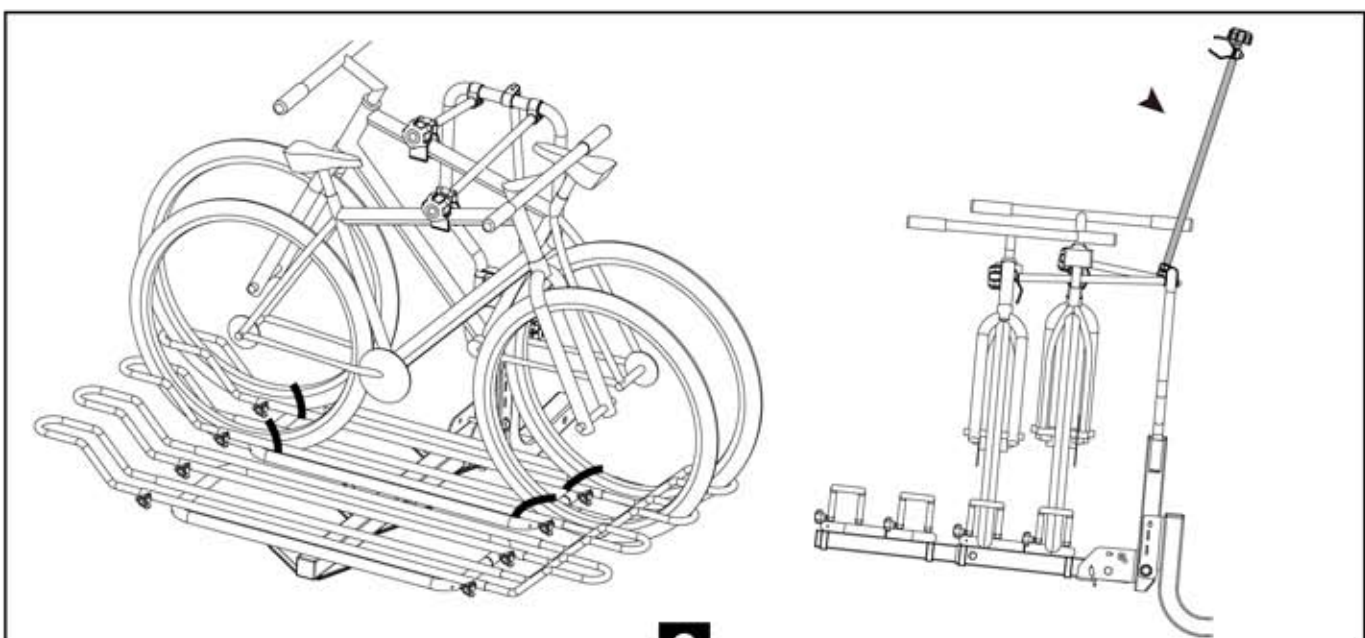
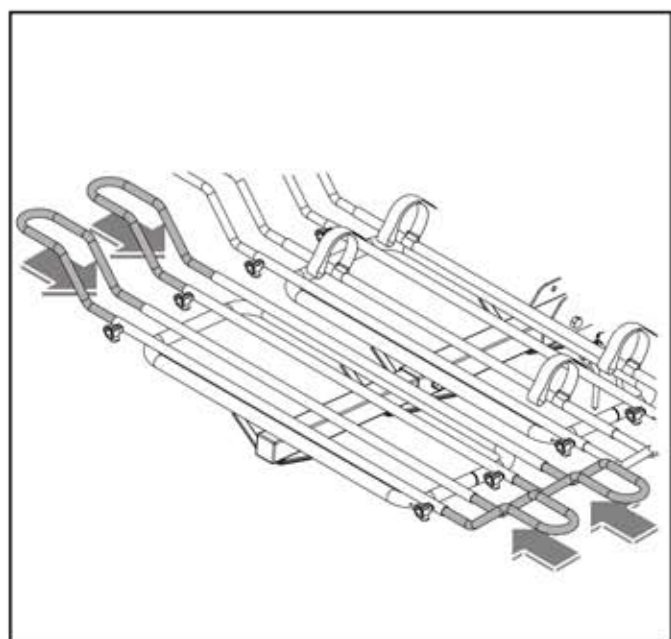
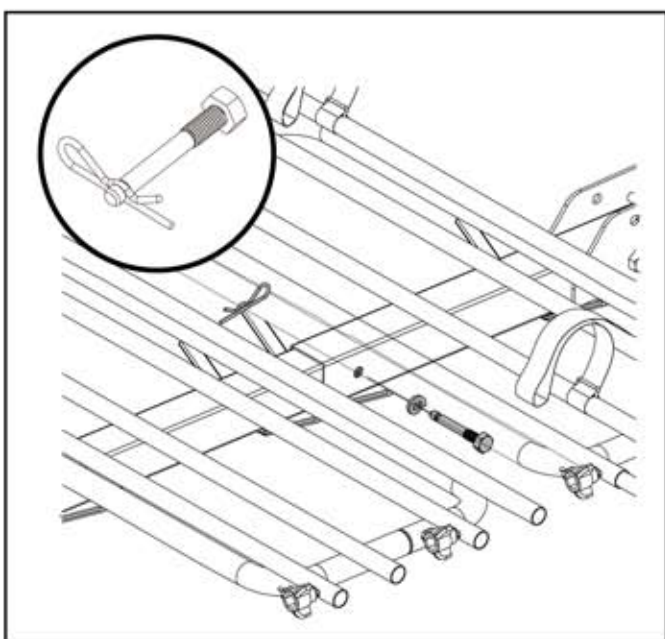
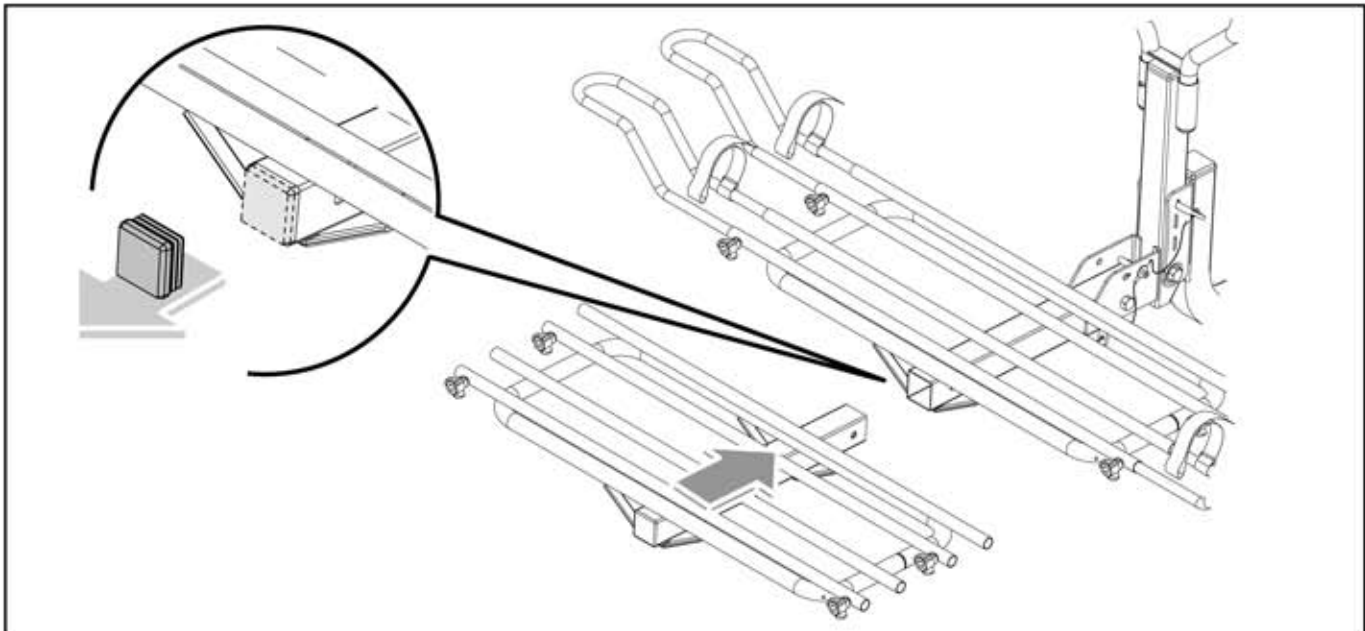

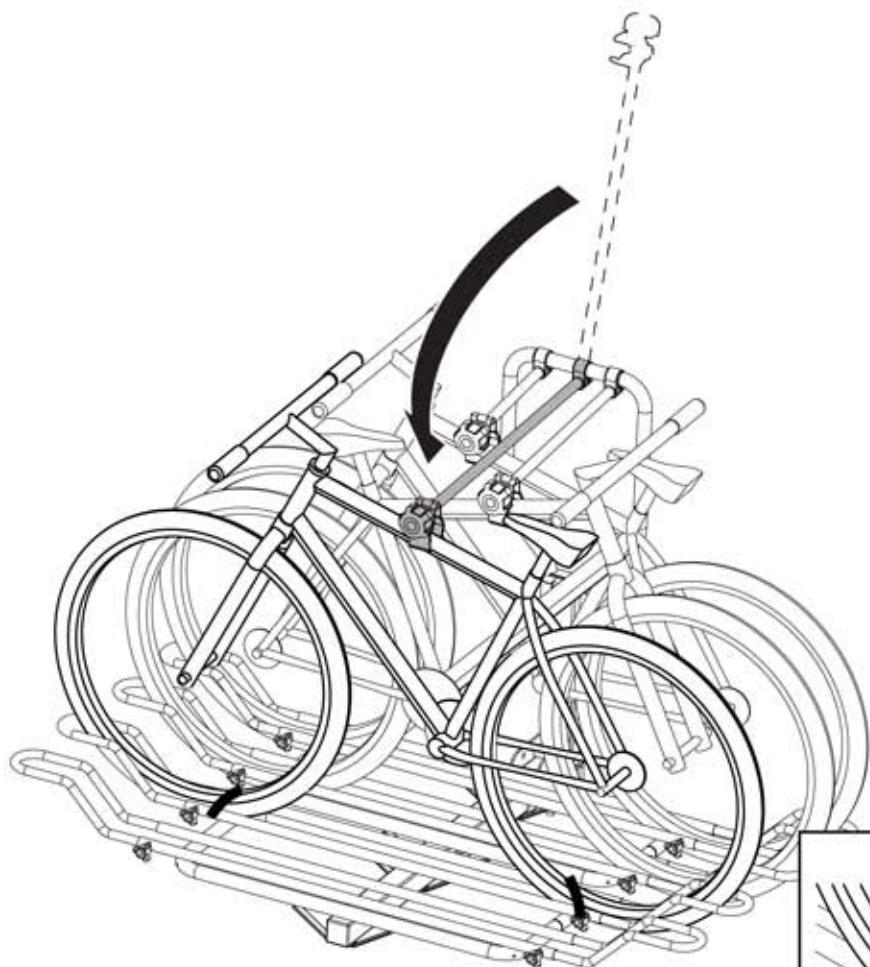

*** It's recommended to install the lower bike frame on tray 1 and tray 2 positions.**

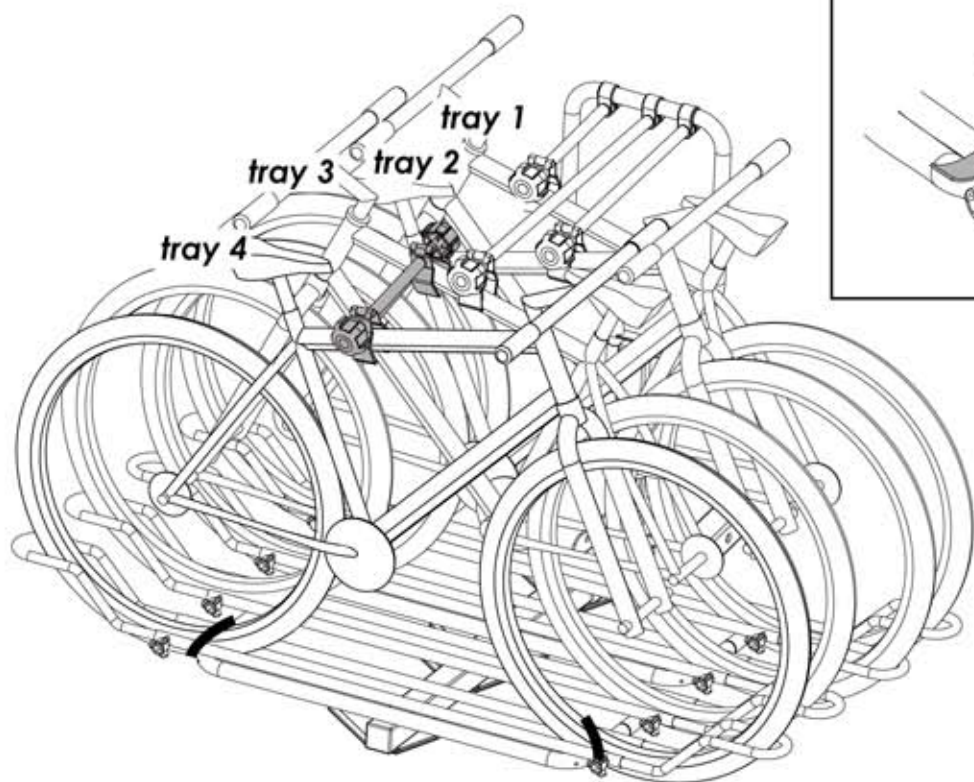
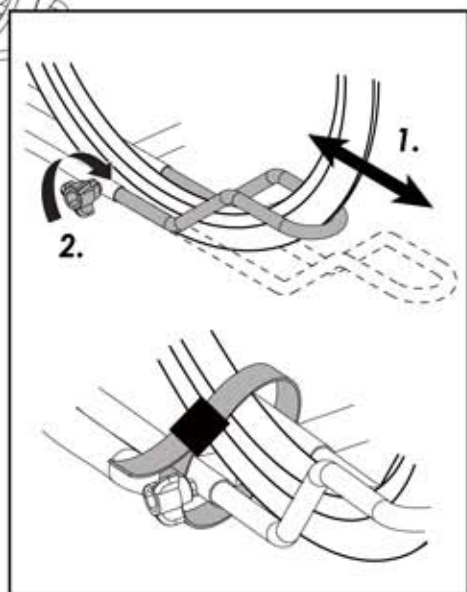

WHEN FOLDING...

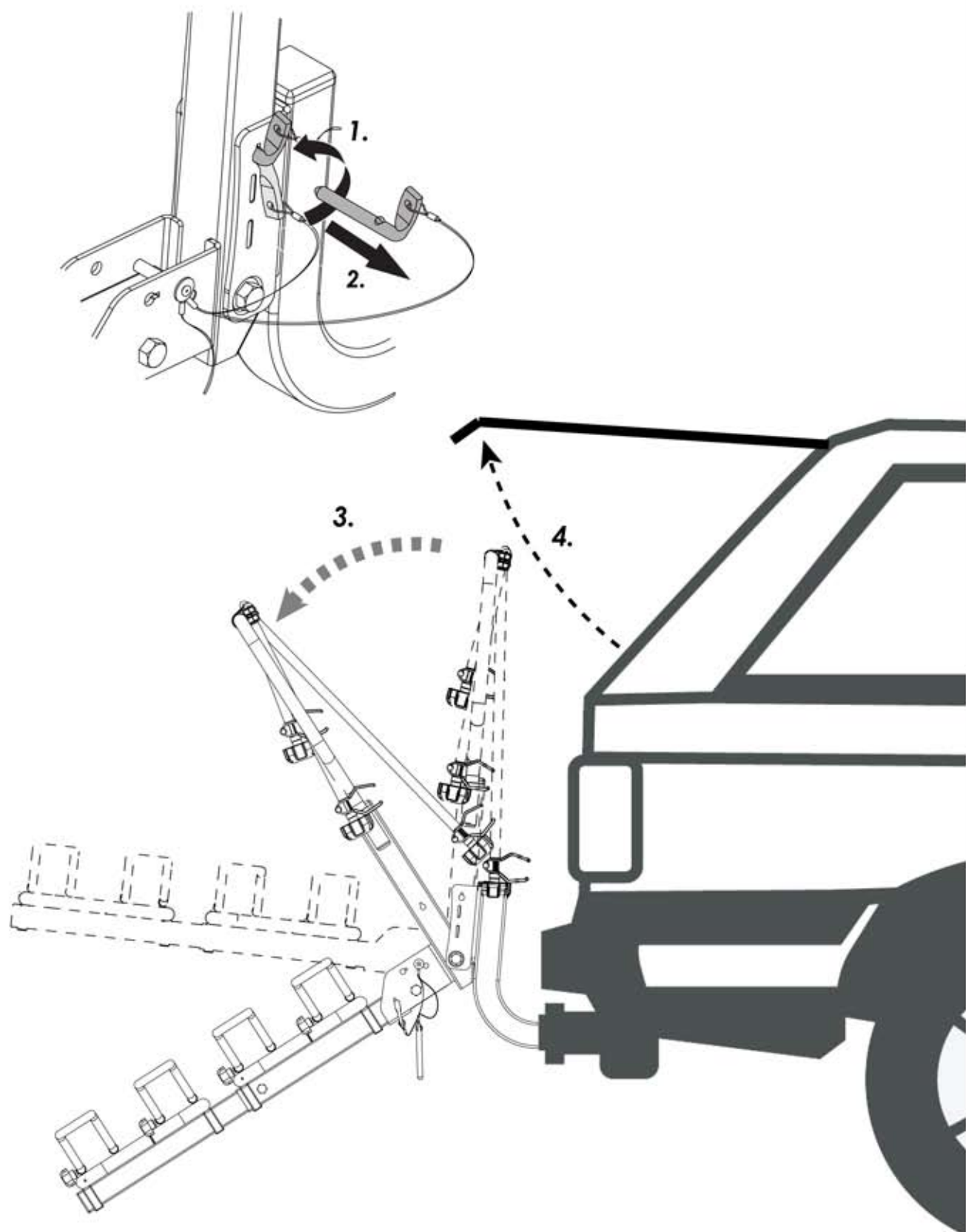

SUGGESTION :

Do not tilt the rack with bicycles attached. If you lose control of the rack, the rack may fall down too quick and cause personal injury.